

Spare Part Listing

SPL Serial No.: ACEG-2009090101

TTI Model No. : 099611001

Description: 230~240V \ 1500W AC EDGER \ HED1520

Customer No.: HED 1520

Revision	ECR No.	Effective Date	Checked By	Change Description Details
01	HL-ECR0908038	1-Sep-09	Vigor.pan	release spare part listing

ITEM	TTI P/N	COMPONENT NO. DESCRIPTION	QTY	REMARK
1	099611001001	Spring Cord	1	<div style="border: 2px solid blue; padding: 5px; text-align: center;"> Homelite Uncontrolled copy for reference copy (D.C.C) </div>
2	099611001002	Screw (M4 x 16mm)	30	
3	099611001003	Handle Housing L	1	
4	099611001004	Switch	1	
5	099611001005	Trigger	1	
6	099611001006	electric capacity	1	
7	099611001007	Cord clamp	1	
8	099611001702	Handle Housing R Assembly	1	
9	099611001009	Power Cord	1	
10	099611001010	Auxiliary Handle	1	
11	099611001011	Auxiliary Handle Collar	1	
12	099611001012	Upper pole	1	
13	099611001013	Upper Collar	1	
14	099611001014	Lower Collar	1	
15	099611001703	Lower Pole Assembly	1	
16	099611001016	Ari Damper	1	
17	099611001017	Screw (M4 x 30 mm)	3	
18	099611001018	Axle Pin	1	
19	099611001019	Axle	1	
20	099611001020	motor housing R	1	
21	099611001021	Screw (M6 x 41 mm)	2	
22	099611001022	Motor Cover	1	
23	099611001023	Wheel	2	
24	099611001024	washer(M8)	2	
25	099611001025	Lock Nut	2	
26	099611001704	motor housing R Assembly	1	
27	099611001701	motor Assembly	1	
28	099611001027	Depth Adjustment Knob	1	
29	099611001028	Nut (M4)	4	
30	099611001029	Ari Outlet	1	
31	099611001030	Screw (M4 x 12mm)	1	
32	099611001031	Ari Outlet Cover	1	
33	099611001705	Motor Hosing L Assembly	1	
34	099611001033	screw (M4 x 45mm)	4	
35	099611001034	Front Wheel Cap	1	
36	099611001035	Front Wheel Axle	1	
37	099611001036	Torsion Spring	1	
38	099611001037	Front Wheel	1	
39	099611001038	Front Wheel Arm Axle Pin	1	
40	099611001039	Front Wheel Arm	1	
41	099611001040	Lock Nut (M6)	1	
42	099611001041	Hex Nut (M6)	1	
43	099611001700	Guard Assembly	1	
44	099611001043	screw (M4 x 50mm)	4	
45	099611001044	Blade Nut(M10)	1	
46	099611001045	Blade Washer	2	
47	099611001046	Blade	1	
48	099611001047	Lock Nut(M8)	1	
49				
50				

100119660		SIZE
TOLERANCE FOR PLASTIC		4
DIVISION DIMENSION	TOLERANCE (CLASS 5)	
-10	±0.10	
10-30	±0.15	
30-50	±0.20	
50-75	±0.25	
75-100	±0.30	
100-125	±0.35	
125-150	±0.40	
150-175	±0.45	
175-200	±0.50	
200-250	±0.60	
250-315	±0.70	

REVISIONS				
REV	ZONE	DESCRIPTION	ECR	CHECKED
01		DESIGN RELEASE	LEI/PJB 07/07/09	HL0908038 PJB 09/01/09
COMPUTERIZED DOCUMENT NO MANUAL REVISIONS PERMITTED				

Homelite
Uncontrolled copy
for reference copy
(D.C.C)

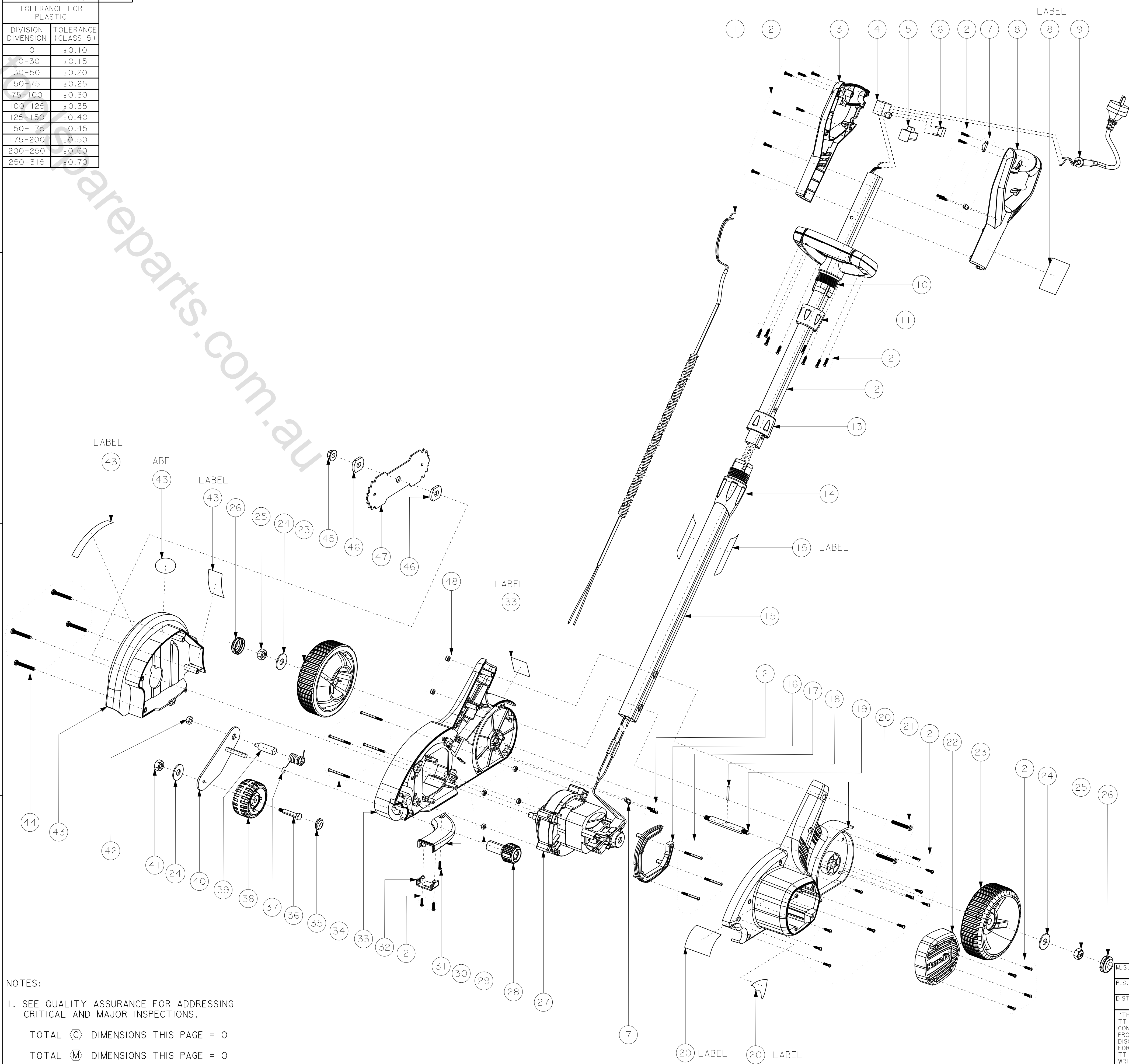

NOTES:
1. SEE QUALITY ASSURANCE FOR ADDRESSING CRITICAL AND MAJOR INSPECTIONS.
TOTAL (C) DIMENSIONS THIS PAGE = 0
TOTAL (M) DIMENSIONS THIS PAGE = 0

099611001		230-240V 1500W AC EDGER / HED1520 / SAA		AS PURCHASED	
PART NUMBER		DESCRIPTION		REMARKS	
UNLESS OTHERWISE SPECIFIED DIMENSIONS ARE IN MILLIMETERS.		DRAWN BY LEI 12/03/08		DATE TTI GROUP NORTH AMERICA	
FOR ALL UNSPECIFIED DIMENSIONS PLEASE REFER TO THE CAD FILE.		CHECKED BY PJB 12/03/08		DATE 230-240V 1500W AC EDGER / HED1520 / SAA	
DO NOT SCALE.		APPROVED BY ZHJ 12/03/08		DATE TTIA / TTINZ	
USE DIMENSIONS ONLY. DIMENSION & TOLERANCE PER ASME Y14.5M-1994		MATERIAL NONE		SIZE 4	
THIRD ANGLE PROJECTION		DRAWING NUMBER 099611001		REV 01	
		SCALE NONE		SHEET OF	