

STANDARD TOLERANCE GRADES (ISO 286-1:1988)	
DIMENSION RANGE	IT 12
0-3	±0.05
3-6	±0.06
6-10	±0.08
10-18	±0.09
18-30	±0.1
30-50	±0.13
50-80	±0.15
80-120	±0.18
120-180	±0.20
180-250	±0.23
250-315	±0.26
315-400	±0.29
400-500	±0.32
500-630	±0.35
630-800	±0.40
800-1000	±0.45

REV	CHANGE DESCRIPTION	ZONE	EC #	DATE	APV BY

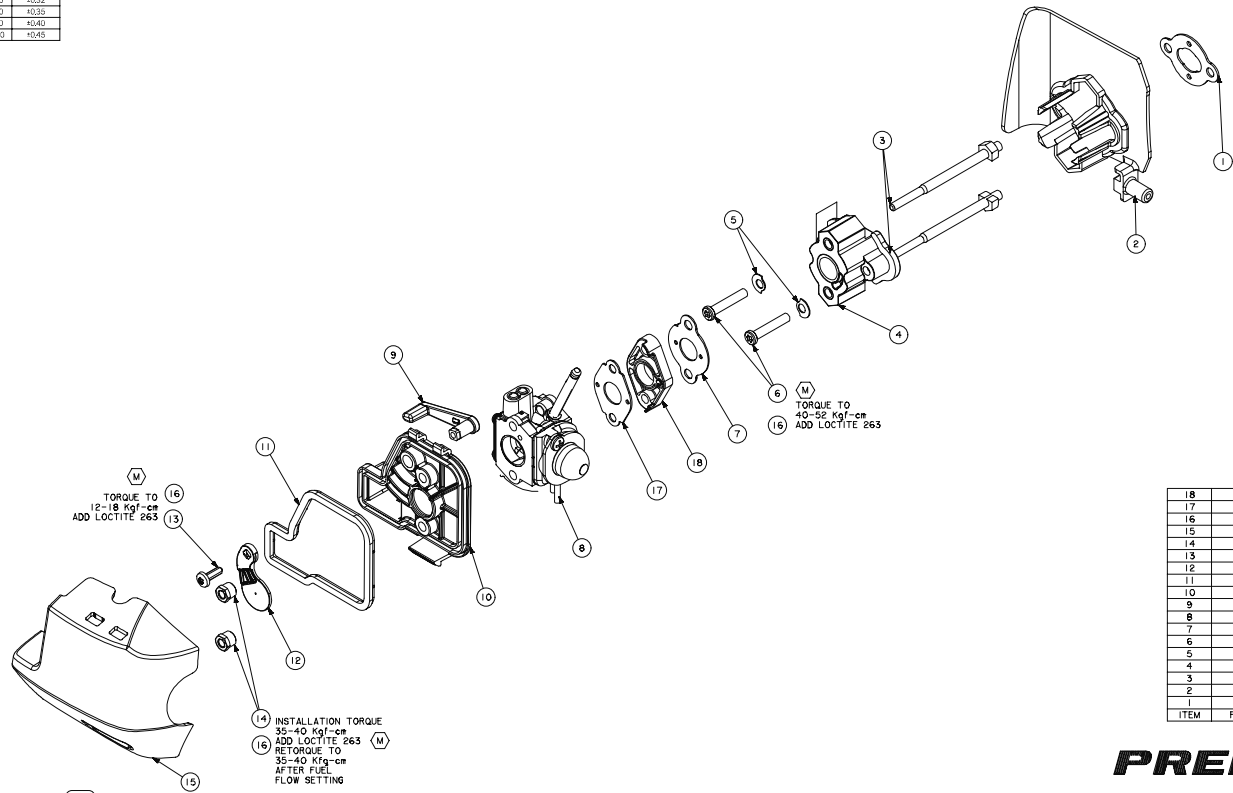

TORQUE TO 12-18 Kgf-cm ADD LOCTITE 263

TORQUE TO 40-52 Kgf-cm ADD LOCTITE 263

INSTALLATION TORQUE 35-40 Kgf-cm ADD LOCTITE 263 RETORQUE TO 35-40 Kgf-cm AFTER FUEL FLOW SETTING

18	590456004	SPACER-PLASTIC	1
17	900994012	GASKET, CARBURETOR	1
16	900239048	LOCTITE 263	
15	521852001	COVER-AIR BOX	1
14	678868001	NUT, HEX M5 X 0.8	2
13	660345001	SCREW, PAN HD	1
12	521608001	CHOKE PLATE	1
11	570107003	GASKET, AIRBOX	1
10	521851001	AIR BOX BASE	1
9	521850002	CHOKE LEVER	1
8	308054091	CARBURETOR, HI42A	1
7	901552002	GASKET, CARB	1
6	660927003	HEAT DAM MOUNTING BOLT	2
5	638659002	HEAT DAM WASHER	1
4	518920001	HEAT DAM	1
3	660927009	CARB BOLT M5X0.8	2
2	521505003	BAFFLE PLATE, PLASTIC	1
1	901551001	INNER HEAT DAM GASKET	1
ITEM	PART NUMBER	DESCRIPTION	QTY

- NOTES:
- REFER TO COMPONENT DRAWING FOR INSPECTION CRITERIA
  - SEE QUALITY ASSURANCE FOR ADDRESSING CRITICAL AND MAJOR DIMENSIONS
- TOTAL (C) THIS PAGE = 0  
TOTAL (M) THIS PAGE = 4

**PRELIMINARY**

	308054096	METRIC	UNLESS OTHERWISE SPECIFIED	
	CONFIDENTIAL	PART NUMBER	DRAWING NUMBER	REV
THE DRAWING IS THE PROPERTY OF TECHTRONIC INDUSTRIES CO. LTD. AND IS NOT TO BE REPRODUCED OR TRANSMITTED IN ANY FORM OR BY ANY MEANS, ELECTRONIC OR MECHANICAL, INCLUDING PHOTOCOPYING, RECORDING, OR BY ANY INFORMATION STORAGE AND RETRIEVAL SYSTEM.	308054096	26cc HOMELITE CARB ASSY	1-11	1-11
DATE	BY	CHECKED	DATE	DATE
12	13	14	15	16