

| TOLERANCE FOR PLASTIC |           |           |
|-----------------------|-----------|-----------|
| DIVISION              | TOLERANCE | TOLERANCE |
| DIMENSION             | (CLASS 5) | (CLASS 5) |
| -10                   | ±0.10     |           |
| 10-30                 | ±0.15     |           |
| 30-60                 | ±0.20     |           |
| 60-75                 | ±0.25     |           |
| 75-100                | ±0.30     |           |
| 100-125               | ±0.35     |           |
| 125-150               | ±0.40     |           |
| 150-175               | ±0.45     |           |
| 175-200               | ±0.50     |           |
| 200-250               | ±0.60     |           |
| 250-315               | ±0.70     |           |

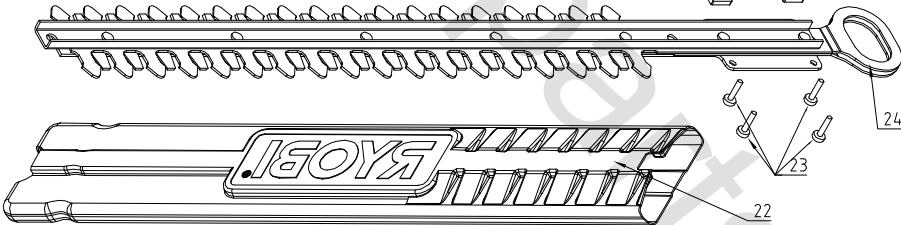

POWER PACK (18V)

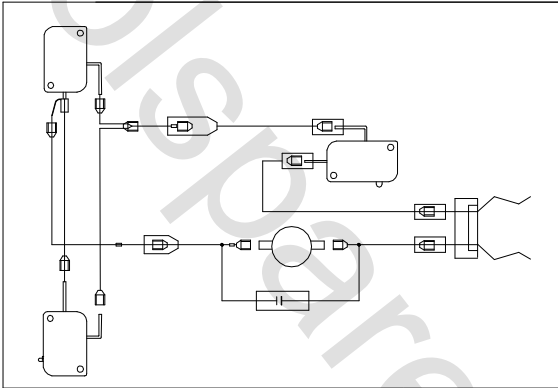

NOTES:  
1. SEE QUALITY ASSURANCE FOR ADDRESSING CRITICAL AND MAJOR INSPECTIONS.  
TOTAL DIMENSIONS THIS PAGE = 0  
TOTAL DIMENSIONS THIS PAGE = 0

Homelite  
Uncontrolled copy  
for reference copy  
(D.C.C)

| REVISIONS  |      |                |           |             |
|--|------|----------------|-----------|-------------|
| REV  | ZONE | DESCRIPTION    | ECR       | CHECKED     |
| 01   |      | DESIGN RELEASE | HL1009033 | FH 25/09/10 |
| COMPUTERIZED DOCUMENT<br>NO MANUAL REVISIONS PERMITTED |      |                |           |             |

|   |  |                           |  |                         |  |
|---|--|---------------------------|--|-------------------------|--|
| 090905021 01  |  | 18VDC HEDGE TRIMMER       |  | AS PURCHASED            |  |
| PART NUMBER   |  | DESCRIPTION               |  | REMARKS                 |  |
| DRAWN BY<br>FH 17/09/10   |  | DATE<br>17/09/10          |  | TTI GROUP NORTH AMERICA |  |
| CHECKED BY<br>GJZ 17/09/10  |  | DATE<br>17/09/10          |  | 18V DC HEDGE TRIMMER    |  |
| APPROVED BY<br>ZHU 17/09/10   |  | DATE<br>17/09/10          |  | SEE NOTE 1              |  |
| MATERIAL  |  | SCALE                     |  | SHEET 1 OF 1            |  |
| UNLESS OTHERWISE SPECIFIED<br>DIMENSIONS ARE IN<br>MILLIMETERS.<br>FOR ALL UNSPECIFIED<br>DIMENSIONS PLEASE REFER<br>TO THE CAD FILE.<br>DO NOT SCALE.<br>USE DIMENSIONS ONLY.<br>DIMENSION & TOLERANCE PER<br>ASME Y14.5M-1994 |  | THIRD ANGLE<br>PROJECTION |  | REV<br>01               |  |