

REV	ZONE	DESCRIPTION	EOR	CHECKED
		RELEASED TO PRODUCTION-PRO120A		
COMPUTERIZED DOCUMENT				
NO MANUAL REVISIONS PERMITTED				

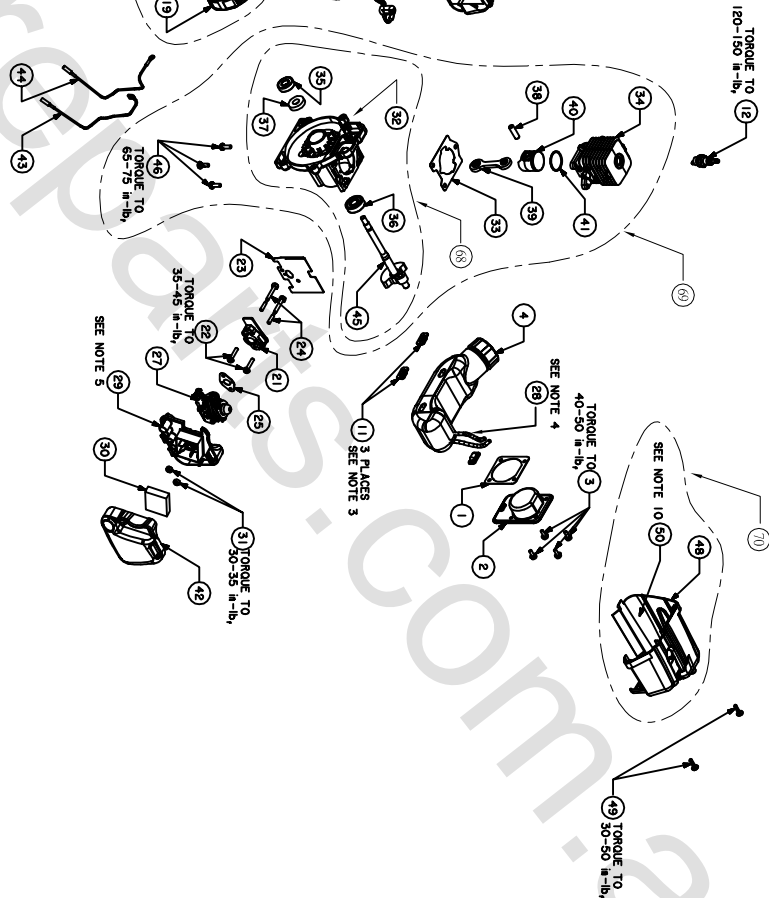
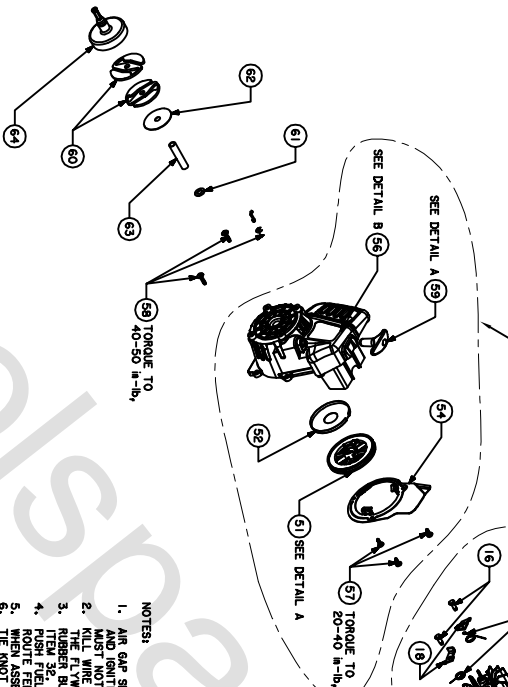
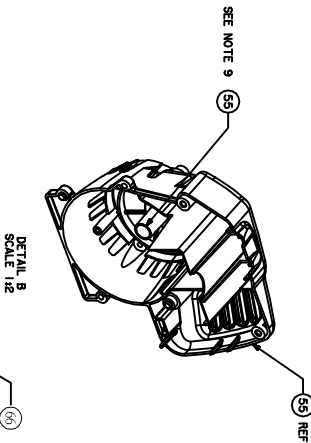
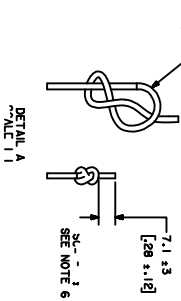

- NOTES:
1. AIR GAP SETTING OF .008/.012 IS TO BE MADE WITH SHIM BETWEEN FLYWHEEL MOUNTS AND IGNITION PICKUPS & PLACES SMALL AMBROSITY, THE IGNITION MODULE AND FLYWHEEL MUST NOT TOUCH EACH OTHER FOR 360° OF FLYWHEEL ROTATION.
 2. KILL WIRE MUST BE PHINCHED, PULL OUT SLACK SO WIRE DOES NOT INTERFERE WITH ROTATION.
 3. RUBBER BUMPERS, ITEM 11, TO BE TAPPED AT ASSEMBLY BY FEATURES ON THE CHAMCKASE, ITEM 32, CHAMCKASE COVER, ITEM 5, AND CORRESPONDING FEATURES ON THE FUEL TANK, ITEM 45.
 4. PISTON FELT LINE AT LEAST 1/4 THE LENGTH OF CARBURETOR TUBE, 2 PLACES USING P-50, ITEM 65.
 5. MOOUE INSIDE THE FUEL TANK, ITEM 45, MUST BE LOOSEER THAN THE SOURCE BEFORE TIGHTENING THE SCREWS.
 6. THE KNOT IN ROPE, ITEM 53, AS SHOWN, TUCK LOOSE END INTO RECESS OF STARTER PULLEY, ITEM 51S, INSTAL SPRING CONTAINER, ITEM 52, AND STARTER PULLEY, ITEM 51, WITH SPRING LOOP OVER POST IN STARTER HOUSING, KENNO STARTER PULLEY 2-2.5 TURNS, INSTAL BATTLE PLATE, ITEM 54, FOR IDENTIFICATION PURPOSES, THE MUFFLER, ITEM 20, FOR REAR HOUSING, ITEM 48.
 8. LAMBERT STARTER POST WITH LIGHT COAT OF GREASE, ITEM 55, BEFORE INSTALING STARTER PULLEY.
 9. ROTATOR AND PAUL ASSEMBLY MUST PASS WITH THIS SPECIFICATION.
 11. THE CLEARANCE BETWEEN THE PAU, ITEM 16, AND PAUL, ITEM 18, MUST BE WITHIN A MIN. OF ROTATING FREELY AND A MAX. OF .203 (.008").

[illegible]