

210070060 DRAWING NUMBER		4 SIZE
TOLERANCE FOR ASSEMBLY		
DIVISION DIMENSION	TOLERANCE (IT 12)	
-10	±0.08	
10-30	±0.11	
30-50	±0.13	
50-80	±0.15	
80-120	±0.18	
120-180	±0.20	
180-250	±0.23	
250-315	±0.26	
315-400	±0.29	
400-500	±0.32	
500-630	±0.35	
630-800	±0.40	
800-1000	±0.45	

REVISIONS				
REV	ZONE	DESCRIPTION	ECM	CHECKED
01		PRELIMINARY	XXXXXXX	XXXXXXXXXXXXX
COMPUTERIZED DOCUMENT NO MANUAL REVISIONS PERMITTED				

PRELIMINARY

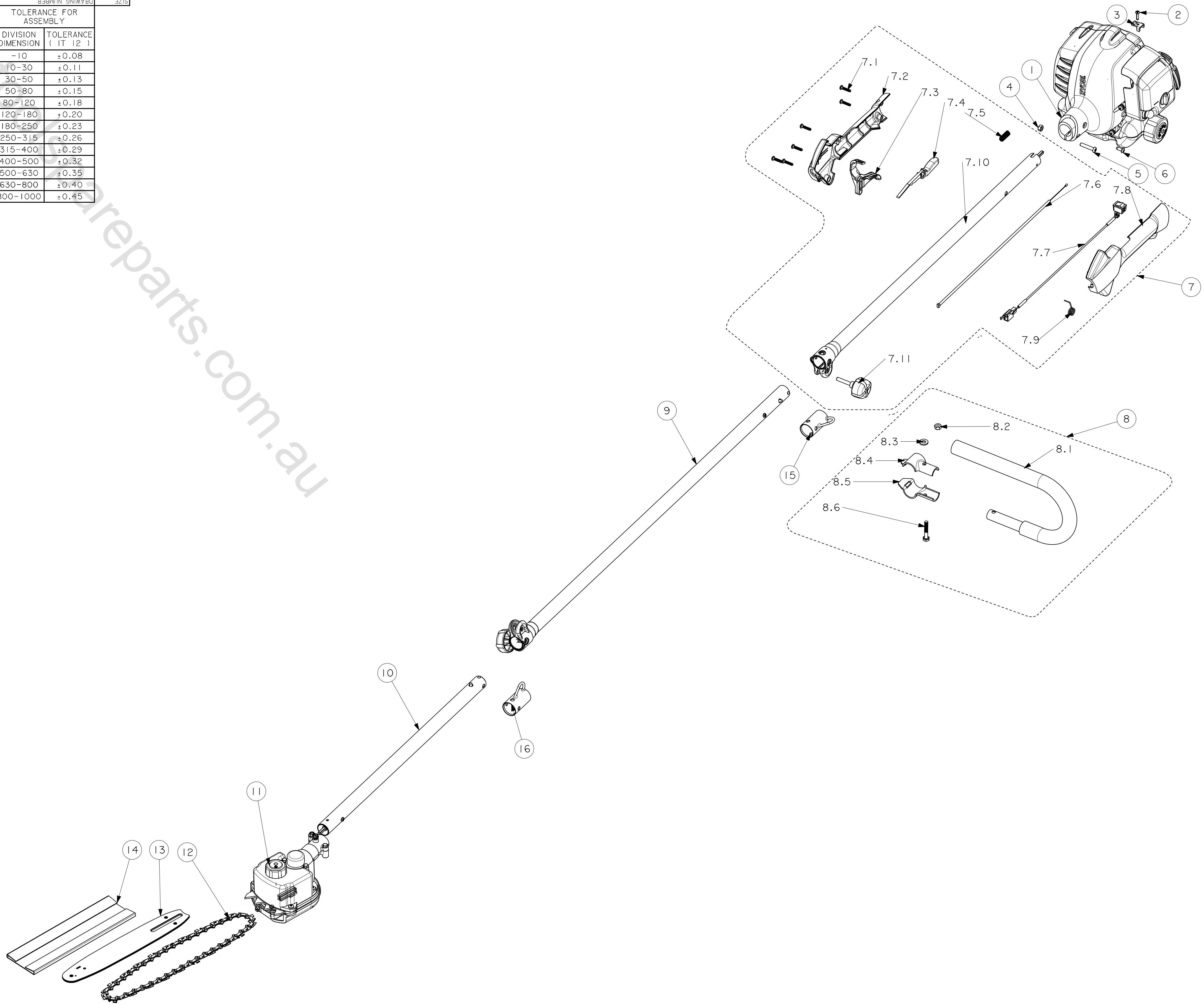

PRELIMINARY

NOTES:

1. REFER TO COMPONENT DRAWING FOR INSPECTION CRITERIA
2. SEE QUALITY ASSURANCE FOR ADDRESSING CRITICAL AND MAJOR DIMENSIONS
- TOTAL THIS PAGE = 0
- TOTAL THIS PAGE = 1

090070012		25.4cc RYOBI TRIMMER CURVE SPLIT BLK SHAFT		AS PURCHASED	
PART NUMBER		DESCRIPTION		REMARKS	
M.S.		UNLESS OTHERWISE SPECIFIED DIMENSIONS ARE IN MILLIMETERS.		DRAWN BY DATE	
P.S.		FOR ALL UNSPECIFIED DIMENSIONS PLEASE REFER TO THE CAD FILE.		LH 12/08/10	
DIST		PURCH/FAB		DATE	
---		P		HJM 12/08/10	
"THIS DRAWING BELONGS TO TTI GROUP NORTH AMERICA. ITS CONTENTS ARE CONFIDENTIAL AND PROPRIETARY AND SHALL NOT BE DISCLOSED TO OR USED BY OR FOR OUTSIDE PARTIES WITHOUT TTI GROUP NORTH AMERICA'S WRITTEN CONSENT."		DO NOT SCALE. USE DIMENSIONS ONLY. DIMENSION & TOLERANCE PER ASME Y14.5-2009		DATE	
THIRD ANGLE PROJECTION		SEE B.O.M		KW.MA 12/08/10	
MATERIAL		SIZE		DRAWING NUMBER	
		4		090070012	
SCALE		NONE		REV	
				01	
		SHEET		OF	
		1		1	